

SET SINGLE-PHASE METER^{VE}

Single-phase meter + smart gateway for dynamic power control and integration with photovoltaic generation.



Technical Datasheet

WM1M6

Mechanical	Dimensions (mm)	36 x 90 x 64
	Mounting	DIN rail
Electrical	Power supply	Single-phase (P+N)
	Maximum current	65 A
	Voltage	230 V AC
	Frequency	50 - 60 Hz
	Cable gauge	1,5 - 16 mm ²
	Certification	MID

SG-E1

Mechanical	Dimensions (mm)	17.5 x 95.4 x 68.2
	Mounting	DIN rail
Electrical	Power supply	Single-phase (P+N)
	Voltage	85 - 265 V AC
	Cable gauge	0,5 - 3 mm ²
Communication	Link to WM1M6	Infrared
	Ethernet connector	RJ45

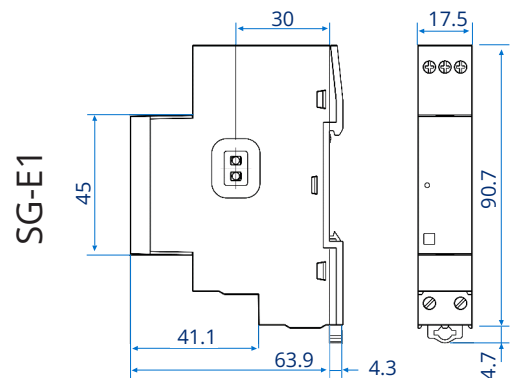
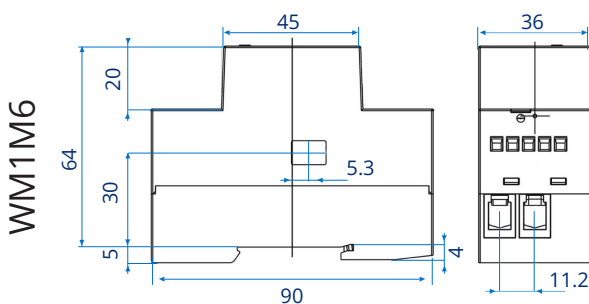

* Source: Iskra manuals